

Heating

Cooling

Fresh Air

Clean Air



Overview of models

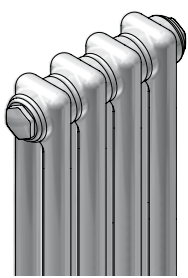

2-column



3-column

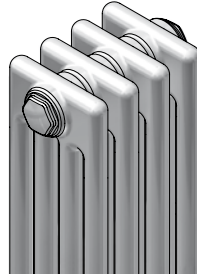

4-column

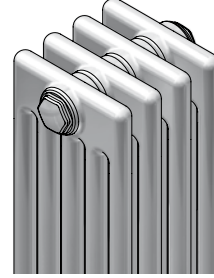

5-column

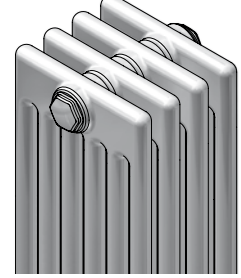

6-column

Product description

The versatile connection options supported by Zehnder Charleston facilitate installation on new and existing pipework, as shown here in the centre of the radiator.

Benefits

- Classic elegance
- Safety
- Cleaning with Zehnder lambswool cleaning brush
- Simple and secure: assembly with Zehnder EasyFix
- Successful connection with Zehnder Vario
- Radiant heat with feel-good factor
- Energy-efficient for use in low-temperature systems

Connection to central heating system/ Technical specifications per section

2-column Depth – 62 mm			3-column Depth – 100 mm			4-column Depth – 136 mm			5-column Depth – 173 mm			6-column Depth – 210 mm		
Model	H mm	Φ_s EN 442 ① W	Model	H mm	Φ_s EN 442 ① W	Model	H mm	Φ_s EN 442 ① W	Model	H mm	Φ_s EN 442 ① W	Model	H mm	Φ_s EN 442 ① W
2019	177	14.5	3019	185	20.1	4019	200	28.4	5019	200	35.0	6019	200	41.5
2026	260	21.1	3026	260	27.9	4026	260	36.5	5026	260	45.1	6026	260	54.0
2030	292	23.6	3030	300	32.0	4030	300	41.9	5030	300	51.7	6030	300	61.3
2035	342	27.5	3035	350	37.0	4035	350	48.5	5035	350	59.9	6035	350	71.0
2040	392	31.2	3040	400	41.9	4040	400	54.9	5040	400	67.9	6040	400	80.5
2045	442	34.9	3045	450	46.8	4045	450	61.3	5045	450	75.8	6045	450	89.8
2050	492	38.4	3050	500	51.6	4050	500	67.6	5050	500	83.5	6050	500	99.0
2055	542	41.9	3055	550	56.3	4055	550	73.7	5055	550	91.0	6055	550	108.0
2060	592	45.3	3060	600	60.9	4060	600	79.8	5060	600	98.6	6060	600	117.0
2075	742	55.0	3075	750	74.3	4075	750	97.4	5075	750	120.0	6075	750	143.0
2090	892	63.9	3090	900	87.0	4090	900	114.0	5090	900	141.0	6090	900	167.0
2100	992	69.5	3100	1000	95.1	4100	1000	125.0	5100	1000	154.0	6100	1000	183.0
2110	1092	74.7	3110	1100	103.0	4110	1100	135.0	5110	1100	167.0	6110	1100	198.0
2120	1192	82.7	3120	1200	115.0	4120	1200	147.0	5120	1200	179.0	6120	1200	210.0
2150	1492	104.0	3150	1500	140.0	4150	1500	180.0	5150	1500	219.0	6150	1500	256.0
2180	1792	124.0	3180	1800	166.0	4180	1800	213.0	5180	1800	259.0	6180	1800	303.0
2200	1992	138.0	3200	2000	183.0	4200	2000	234.0	5200	2000	285.0	6200	2000	334.0
2220	2192	151.0	3220	2200	200.0	4220	2200	256.0	5220	2200	312.0	6220	2200	365.0
2250	2492	171.0	3250	2500	225.0	4250	2500	289.0	5250	2500	352.0	6250	2500	412.0
2280	2792	189.0	3280	2800	251.0	4280	2800	323.0	5280	2800	392.0	6280	2800	459.0
2300	2992	201.0	3300	3000	269.0	4300	3000	345.0	5300	3000	420.0	6300	3000	491.0

H = Height

① = Thermal output per section measured according to EN 442, ΔT 50 K (75/65/20°C)

ZGIS-LEAF-CHARL, V0311, en, subject to change without notice